

COLOSSUS

Warleggan, Church Street, St Mary's

Sleeps 2 | March - October | Wednesday changeover | £445 - £580 per week

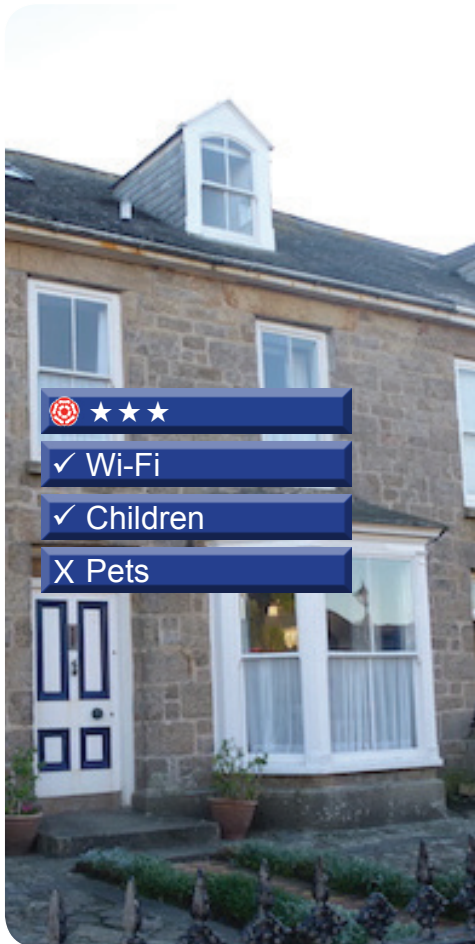

✓ Wi-Fi

✓ Children

X Pets



Colossus is a comfortable ground floor apartment close to the heart of Hugh Town and is convenient for several beaches and the coastal path.

The accommodation comprises an open-plan lounge/kitchen/diner, a bedroom with a double bed and a bathroom with a shower over the bath and heated towel rail.

Fittings include a flat screen television with DVD player and radio, Wi-Fi, vacuum cleaner, hairdryer, iron and ironing board.

Colossus also enjoys its own private sun deck that is accessed from the bedroom.

A perfect choice for couples, Colossus is equally suited to the single traveller.

Layout

Colossus

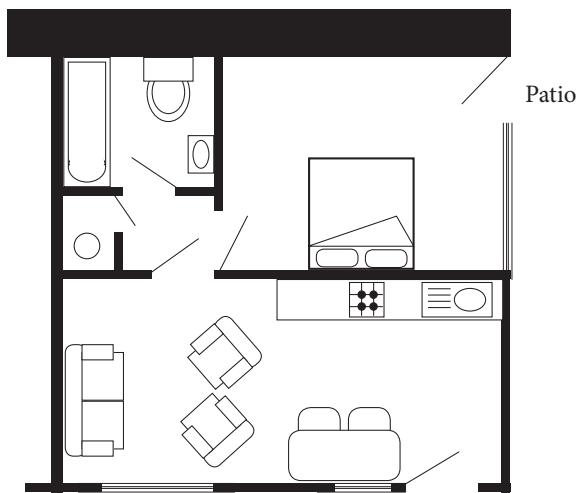

- Sleeps 2
- Double arrangement
- Wi-Fi
- Convenient for beaches
- Children welcome
- Close to town centre

Directions from the Quay Walking time: 6 - 10 minutes

Head towards the entrance to the quay
 Turn left at The Mermaid Inn on to Hugh Street
 Keep to the left side of the road
 Continue along Hugh Street to Bordeaux shop

Cross the road to the Town Hall
 Walk straight ahead on to Church Street
 Warleggan is about 100 yards on the right
 Colossus is situated on the ground floor

