

GODOLPHIN HOUSE, FLAT 2

Church Road, St Mary's

Sleeps 4 | April - October | Friday changeover | £510 - £995 per week



★★★

✓ Wi-Fi

✓ Children

X Pets

This light and airy first floor flat is well-appointed throughout and enjoys glimpses over the sea towards Treseo.

Sleeping four guests in one twin and one double bedroom, the accommodation also comprises a fully fitted kitchen with a washer/dryer, a comfortable lounge with dining space and a family bathroom with electric shower over the bath.

Godolphin House is set in a quiet location within easy access of the main amenities of Hugh Town and there are several beaches nearby.

It is only a ten-minute level walk to the quay, while a ten-minute walk in the opposite direction takes you into Old Town.

Layout

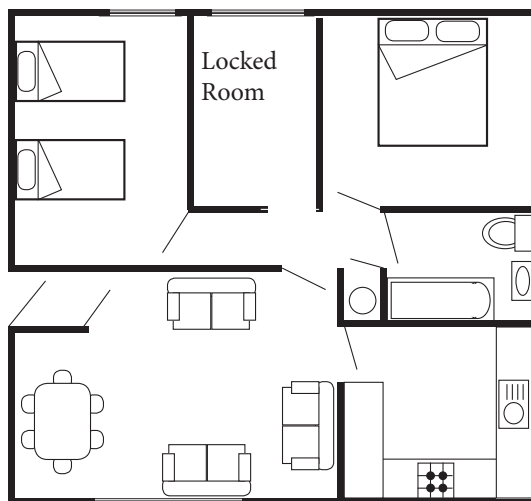

- Sleeps 4
- Double and twin arrangements
- Washing machine
- Internet access
- Children welcome
- Close to town and beaches

Directions from the Quay Walking time: 10 - 12 minutes

Head towards the entrance to the quay
 Turn left at The Mermaid Inn on to Hugh Street
 Keep to the left side of the road
 Continue along Hugh Street to Bordeaux shop
 Cross the road to the Town Hall

Walk straight ahead on to Church Street
 Go past the Parish Church
 Godolphin House is on your right
 Take the entrance on the left
 Flat 2 is on the first floor

